

Cleaning Jammed Paper

Paper jam in the automatic tray

1. Remove the tray.

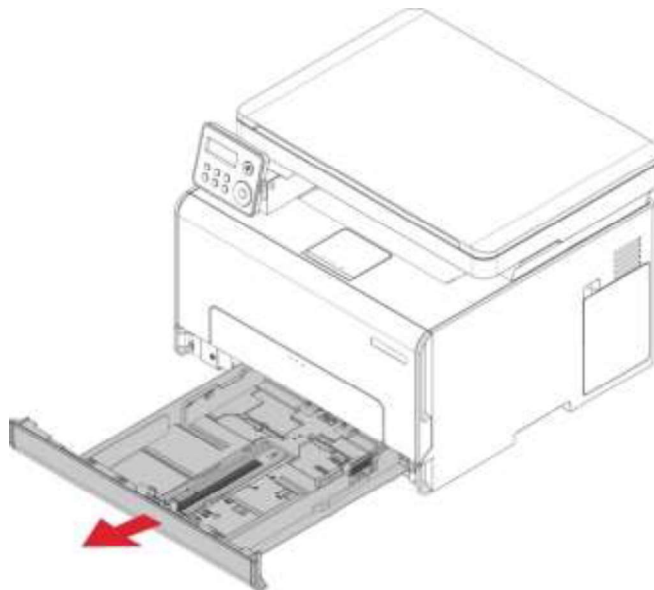

2. Remove the jammed paper.

Note: • Make sure that all paper fragments are removed.

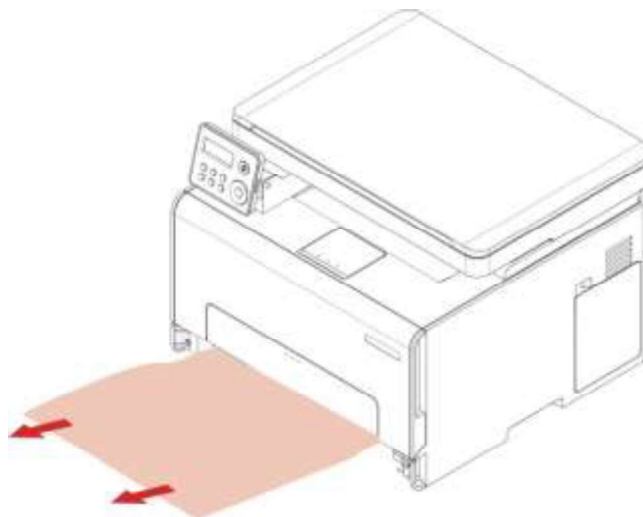

3. Insert the tray.

4. Open the rear cover.



The inside of the printer might be hot. To reduce the risk of injury by a hot component, allow the surface to cool before touching it.

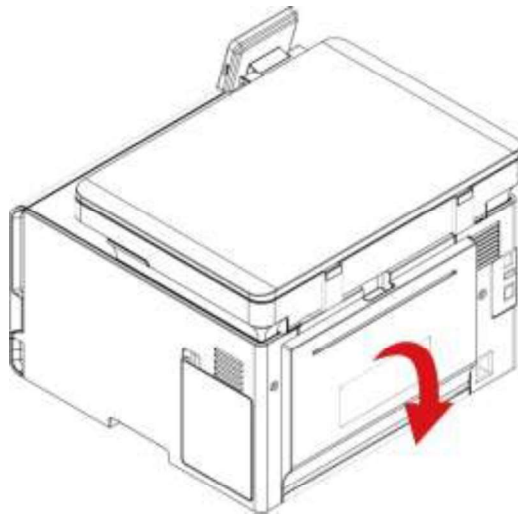

5. Remove the jammed paper.

Note: • Make sure that all paper fragments are removed.

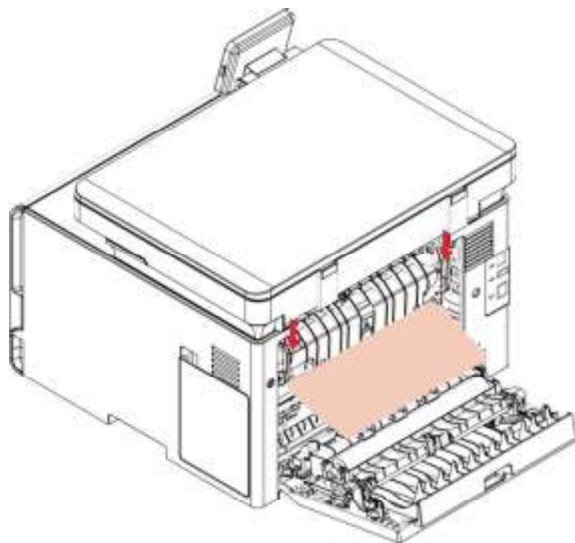

6. Close the cover.

The paper is jammed in the manual feed tray

1. Remove the standard feed tray and press the blue unlock button on the left.

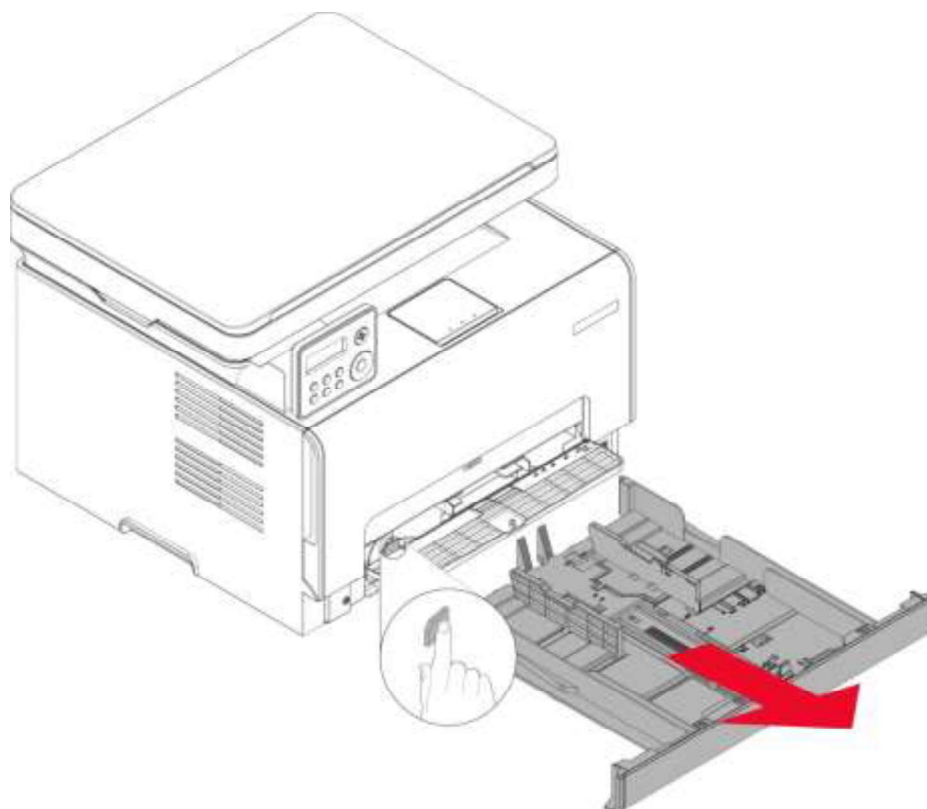

2. Pull out the jammed paper.

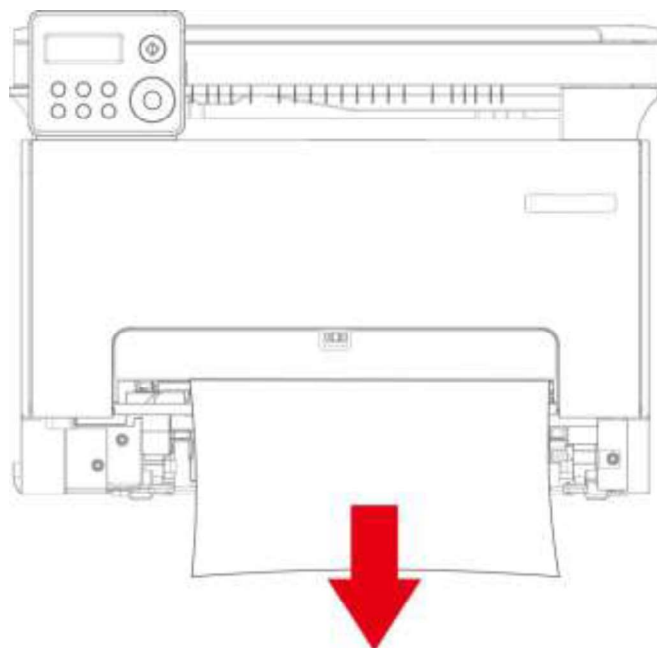

3. Press and push up the metal plate to return it to its original position.

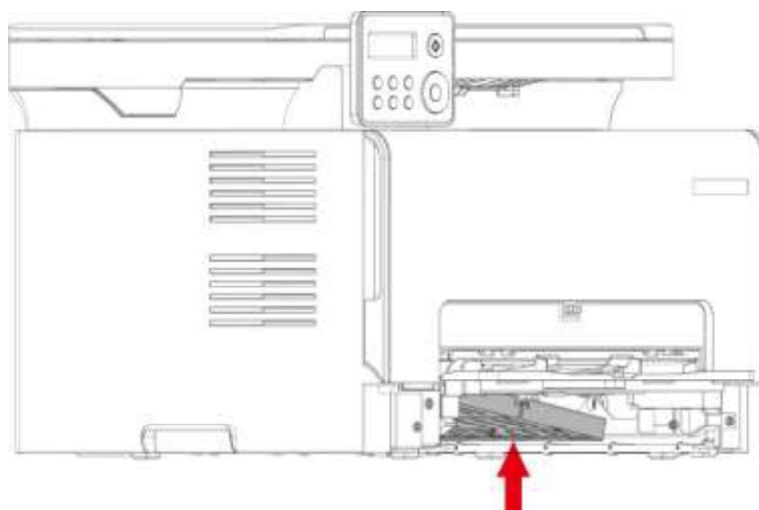

4. Push the standard feed tray in.

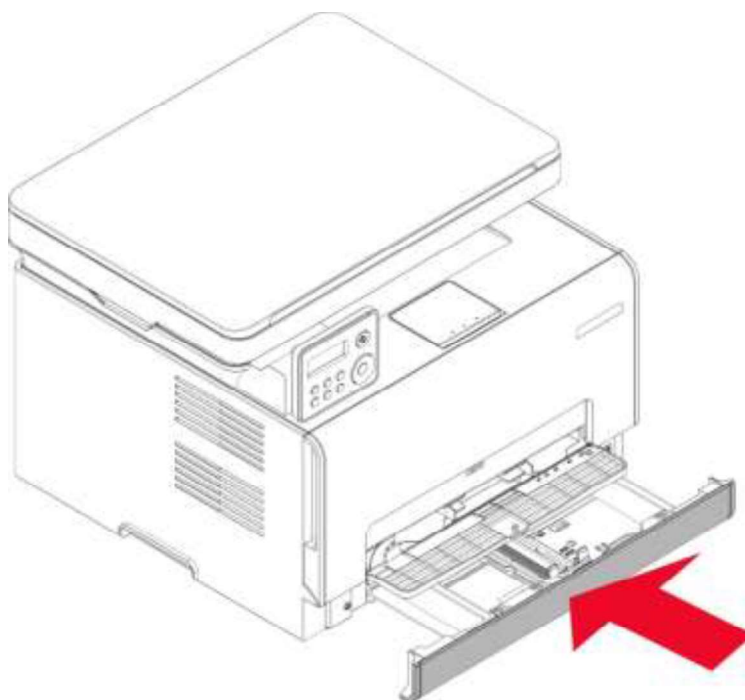

Paper jam in the manual tray

1. Open the front cover, and then push it down hard.

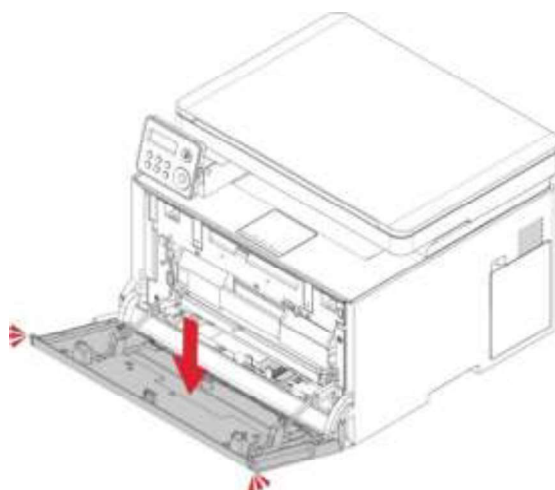
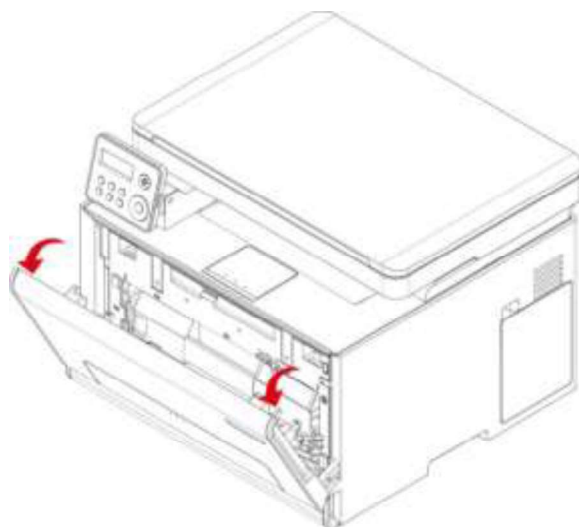

2. Remove the jammed paper.

Note: • Make sure that all paper fragments are removed

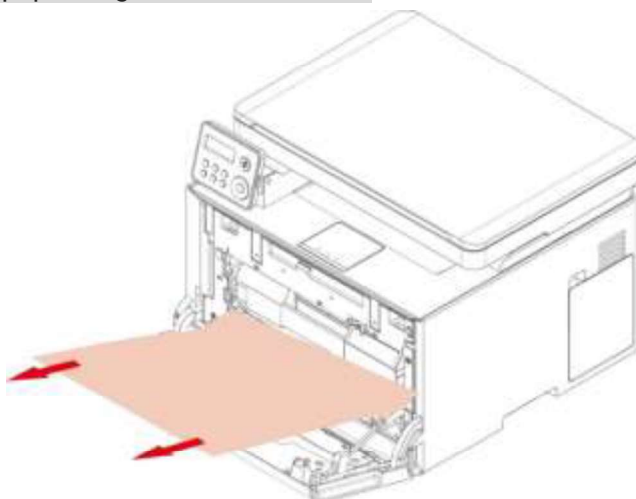

3. Close the front cover.

Paper jam in the rear cover

1. Open the rear cover.



The inside of the printer might be hot. To reduce the risk of injury by a hot component, allow the surface to cool before touching it.

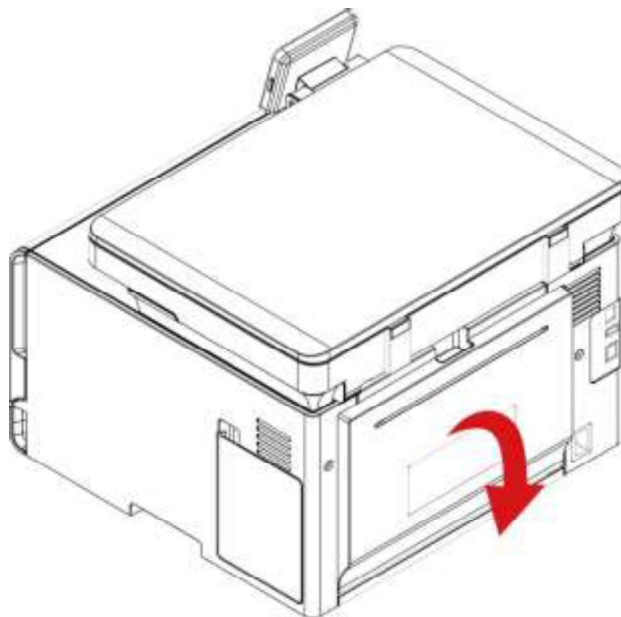

2. Remove the jammed paper.

Note: • Make sure that all paper fragments are removed.

- Fuser area

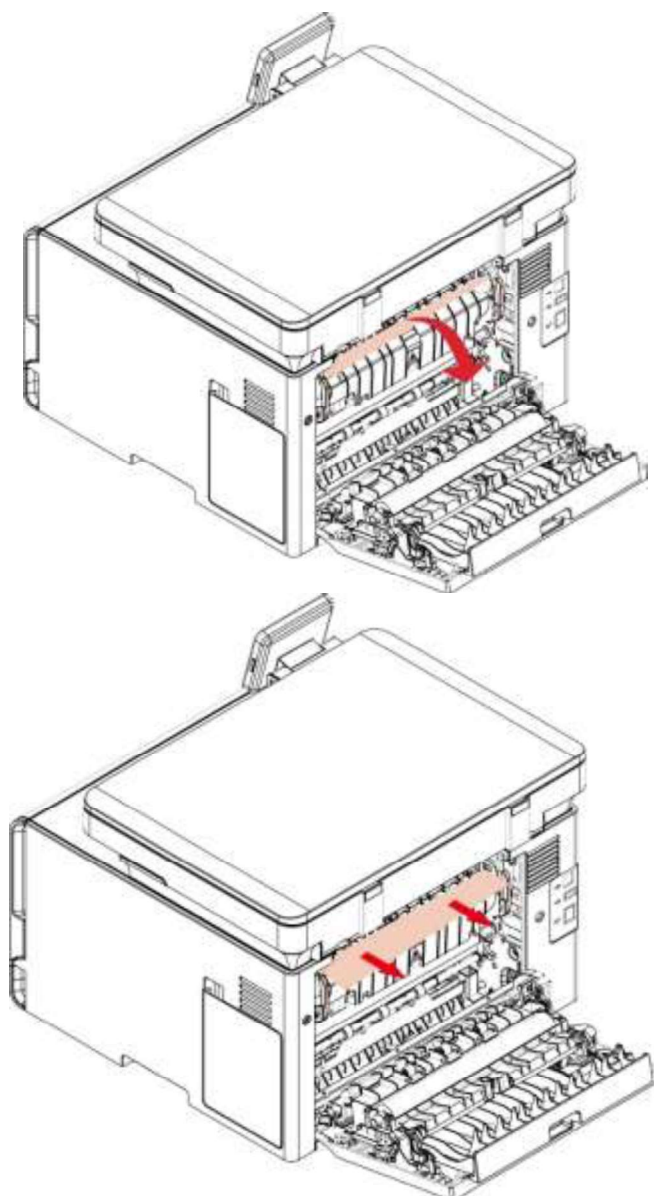

- Below the fuser area

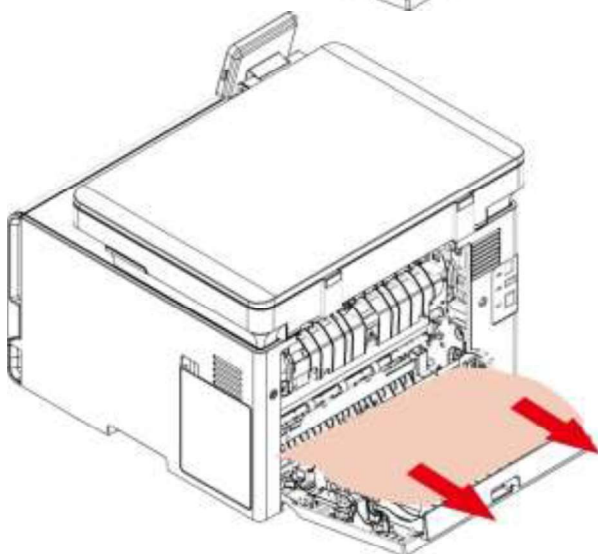
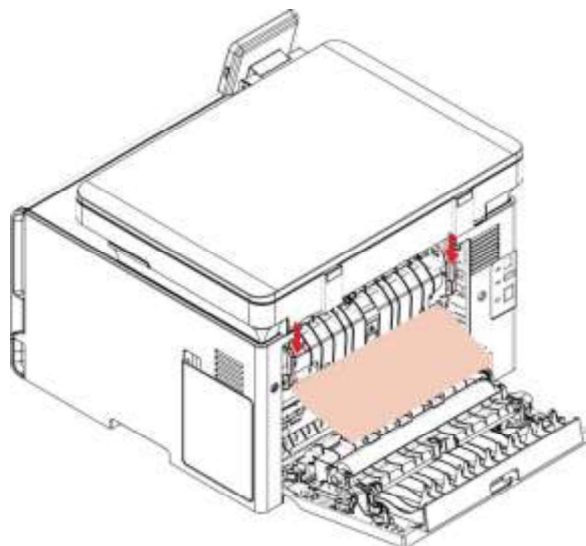

- Duplex unit

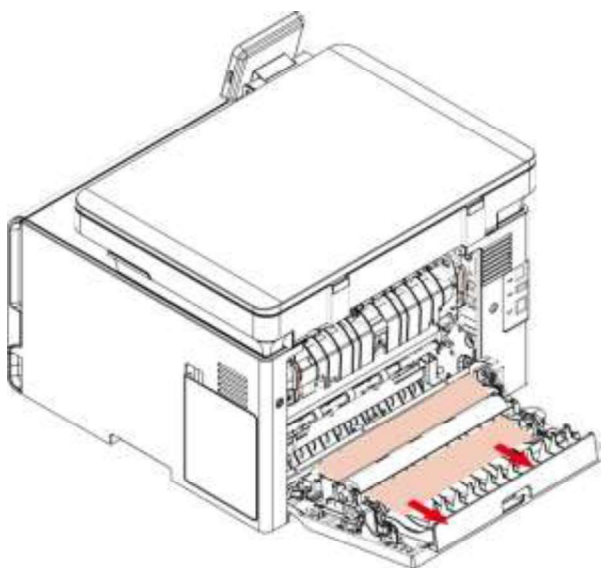

3. Close the cover.